

Official stamp of registrar  
indicating date of receipt

APPENDIX B: *ITEM 5*  
COPY OF THE APPLICATION FORM



*This section for official  
use only*

COMMONS REGISTRATION ACT 1965 SECTION 13

APPLICATION FOR THE REGISTRATION OF LAND  
WHICH BECAME A TOWN OR VILLAGE GREEN  
AFTER 2<sup>ND</sup> JANUARY 1970

<sup>1</sup> *insert name of  
registration authority*

To the <sup>1</sup> *KENT COUNTY COUNCIL*

Application is hereby made for the registration as a town or  
village green of the land described below, which became so  
registrable after 2 January 1970.

Part 1

Name and address of the applicant or (if more than one)  
of every applicant

*(Give Christian names  
or forenames and surname  
or, in the case of a body corporate  
or unincorporate, the full title of the  
body. If part 2 is not completed all  
correspondence and notices will be  
sent to the first named applicant).*

*MARTIN ROSS  
81 St. LEONARDS ROAD  
Hythe  
Kent  
CT 21 6HE*

*Tel: 01-303 267736*

Part 2

Name and address of solicitor, if any.

*(This part should be  
completed only if a solicitor  
has been instructed for the  
purposes of the application.  
If it is completed, all correspondence  
and notices will be sent to the  
solicitor)*

Part 3

Particulars of the land to be registered, i.e. the land claimed to have become a town or village green

Name by which usually known *SOUTH ROAD RECREATION GROUND*

Locality *Hythe*

Colour on plan herewith *Edged Red and coloured YELLOW*

Part 4

*15<sup>th</sup> NOVEMBER 2005*

On what date did the land become a town or village green?

*By the Public Health Act 1875 [1] 9<sup>th</sup> MARCH 1915 and/or*

*By actual use of the land for over [2] More than 20 years ago.*

Part 5

How did the land become a town or village green?

*In 1915 the land was laid out as a public recreation ground under the Public Health Act 1875 and has been used in that way ever since. See attached affidavits and/or statutory declarations. Note the use of the words "Appropriation of Land for Pleasure Ground purposes" in the 12/1/1915 PLAN AND BY THE STATUTORY DECLARATIONS FILED HERewith*

Part 6

Name and address of every person whom the applicant believes to be an owner, leasee, tenant or occupier of any part of the land claimed to have become a town or village green (if none are known, write 'none')

*Hythe Town Council  
Council Offices  
Stade St  
Hythe, Kent*

Part 7

For applications to register substituted land (see Note 5); to be disregarded in other cases.

Particulars of the "taken land" i.e. the land which ceased to be a town or village green (or part thereof) when the land described in part 3 became a town or village green (or part)

Name by which usually known

Locality

Colour on plan herewith (if any)

If registered under the 1965 Act, register unit No(s)

Part 8

List of supporting documents sent herewith, if any. (If none are sent, write "none")

- (1) Copy of the approval of Appropriation of Corporate land with Plan
- (2) Copy of Hyde Town Council Land Certificate Plan showing "Recreation Ground."
- (3) Bundle of supporting statutory declarations.

Part 9

If there are any other facts relating to the application which ought to be brought to the attention of the registration authority (in particular if any person interested in the land is believed to dispute the claim that it has become a town or village green) full particulars should be given here. (Continue on the back if necessary)

The Council are (1) considering fencing the said land and (2) proposing to build on it.

<sup>2</sup>If the application must be signed by or on behalf of each individual applicant, and by the secretary or some other duly authorised officer of any applicant which is a body corporate or unincorporate

Date ..... November 15<sup>th</sup> 2005 .....

Signatures<sup>2</sup> ..... [Signature] .....

(See Note 9)

STATUTORY DECLARATION IN SUPPORT

To be made by the applicant, or by one of the applicants, or by his or their solicitor, or, if the applicant is a body corporate or unincorporate, by its solicitor or by the person who signed the application.

<sup>1</sup>Insert full name (and address if not given in the application form)

<sup>2</sup>Delete and adapt as necessary

<sup>3</sup>Insert name if applicable

I, MARTIN ROSS,  
solemnly and sincerely declare as follows:-

1. <sup>2</sup> I am [(the person (~~one of the persons~~) who (has) (~~have~~) signed the foregoing application) (~~the solicitor to~~ (~~the applicant~~) (~~one of the applicants~~)] and the applicant

2. I have read the Notes to the application form.

3. The facts set out in the application form are to the best of my knowledge and belief fully and truly stated and I am not aware of any other fact which should be brought to the attention of the registration authority as likely to affect its decision on this application, not of any document relating to the matter other than those (if any) mentioned in parts 8 and 9 of the application.

<sup>4</sup>Insert "marking" as on plan

4. The plan now produced and shown to me marked <sup>4</sup>DKR is the plan referred to in Part 3 of the application.

<sup>5</sup>Delete this paragraph if there is no plan referred to in Part 7

5. <sup>5</sup> ~~The plan now produced and shown to me marked <sup>4</sup>\_\_\_\_\_ is the plan referred to in Part 7 of the application.~~

And I make this solemn declaration, conscientiously believing the same to be true, and by virtue of the Statutory Declarations Act 1835.

Declared by the said MARTIN ROSS

at 147 HIGH STREET HYTHE KENT

in the COUNTY of KENT

this 16th day of NOVEMBER 2005

  
Signature of Declarant

Signature L. Taylor Before me

Address .....

Qualification .....

LISA E. TAYLOR  
SOLICITOR  
ROBSON & Co.  
147 HIGH STREET  
HYTHE  
KENT CT21 5JN

REMINDER TO OFFICER TAKING DECLARATION:  
Please initial all alterations and mark any plan as an exhibit.

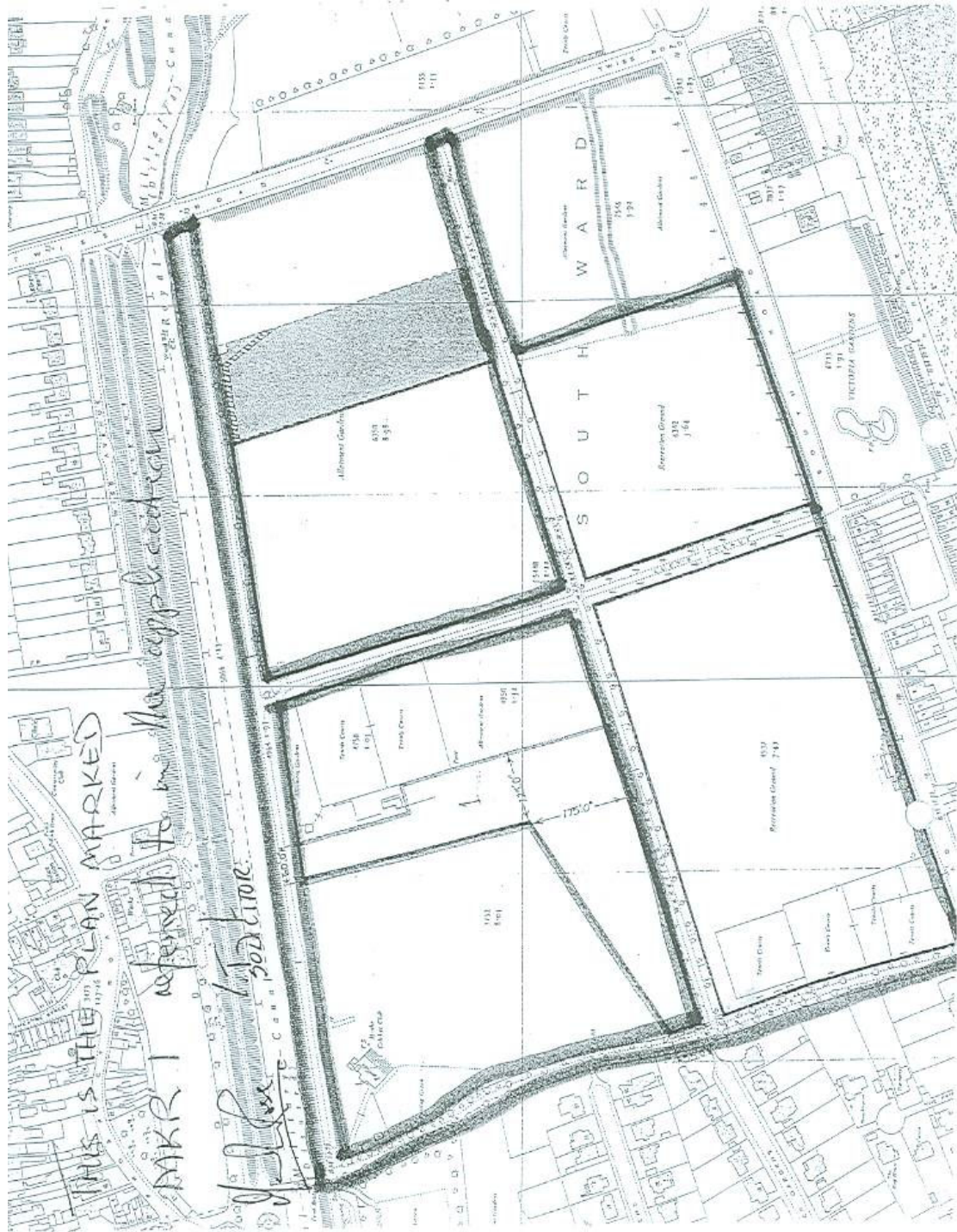

5110